

# Carriage Table

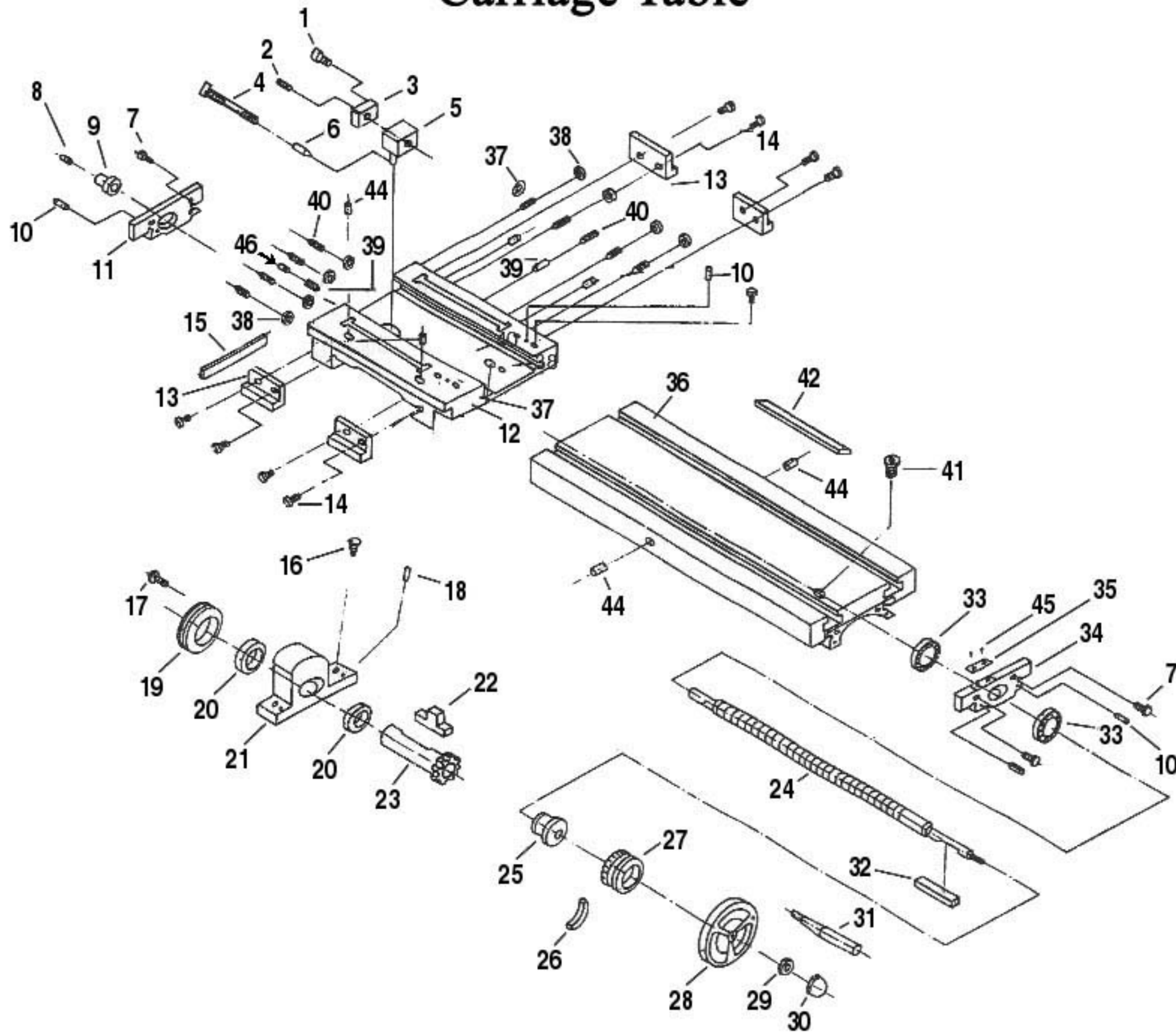

# Carriage Table

Diagram Number	Part Number	Reference Number	Description
1	G08001	S11691	Sockethead capscrew M5x20
2	G08002	S11642	Conepoint slotted setscrew M5x12
3	G08003	6-06	Adjusting nut
4	G08004	GB73	Sockethead capscrew M6x30
5	G08005	6-07	Nut
6	G08006	6-79	Locking pin
7	G08007	S11340	Sockethead capscrew M6x20
8	G08008	GB1155	Oiler
9	G08009	6-01	Bushing (I)
10	G08010	GB117	Taper pin 4x26
11	G08011	6-02	Screw bracket (I)
12	G08012	6-08	Carriage
13	G08013	6-20	Wiper
14	G08014	GB818	Panhead Phillips screw M5x12
15	G08015	6-05	Gib
16	G08016	S11971	Sockethead capscrew M6x16
17	G08017	GB819	Setscrew M4x8
18	G08018	GB117	Taper Pin A4x16

Diagram Number	Part Number	Reference Number	Description
19	G08019	JB24	Locking nut M24x1.5
20	G08020	6-12	Bushing
21	G08021	6-09	Bushing seat
22	G08022	6-10	Key
23	G08023	6-11	Gear sleeve
24	G08024	6-04	Crossfeed screw
25	G08025	6-18	Dial seat
26	G08026	3-19	Spring piece
27	G08027	6-17	Dial
28	G08028	GB4141.22	Handwheel B12x25
29	G08029	GB6172	Jam nut M10
30	G08030	S18160	Acorn nut M10
31	G08031	GB4141.5	Handle M10x80
32	G08032	GB1096	Key 4x28
33	G08033	GB292	Ball bearing 46101
34	G08034	6-16	Screw seat

# Carriage Table

Diagram Number	Part Number	Reference Number	Description
35	G08035	ZQ4124-63	Indicator
36	G08036	6-03	Table
37	G08037	GB79	Sockethead capscrew M10x25
38	G08038	S18125	Hex nut M8
39	G08039	CQ9107.515	Locking pin
40	G08040	Use S11805 / GB79	Dogpoint setscrew M8x45 (M8x50)
41	G08041	GB70	Sockethead capscrew M8x12
42	G08042	6-19	Gib
43	G08043	GB79	Hex-socket setscrews
44	G08044	C30035	Oiler 8 mm
45	G08045	GB827	Rivet 2x5
46	S12618		Locking Bolt M10x25 1.5 Pitch